

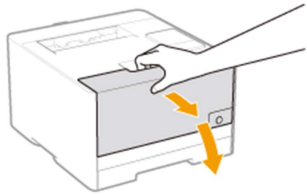

Replacing the Toner Cartridge

Solution

1. Open the front cover.



2. Press the lever and pull out the toner cartridge tray.

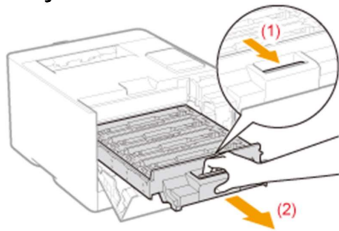

3. Hold the toner cartridge to be replaced by its handle and pull it straight up and out of the printer.

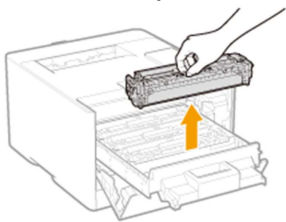

4. Take out the new toner cartridge from the protective bag. You can open the protective bag with your hands from the notch. When opening the

protective bag with scissors, be careful not to damage the toner cartridge.

Keep the protective bag. Do not discard it. You will need it when you remove the toner cartridge for printer maintenance or other purposes.

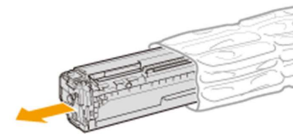

5. Shake the toner cartridge five or six times as shown in the figure to evenly distribute the toner inside the cartridge. Do not remove the drum protective cover (A).

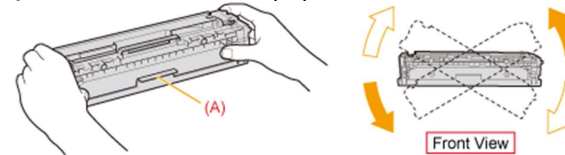

6. Place the toner cartridge on a flat surface.

7. Remove the tab, and then pull out the sealing tape (approx. 20 in. (50 cm)).

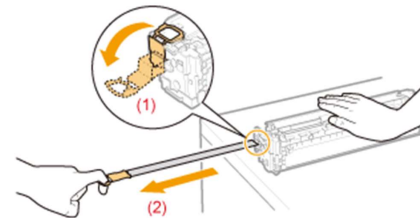

IMPORTANT



Precautions when pulling out the sealing tape

Do not pull the sealing tape diagonally, upward, or downward. If the tape is severed, this may become difficult to pull out completely.

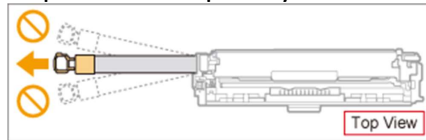

If the sealing tape stops at midpoint, pull it out of the toner cartridge completely.

If any tape remains in the toner cartridge, this may result in poor print quality. Dispose of the removed sealing tape according to local regulations.

8. Remove the drum protective cover (A).

Keep the drum protective cover. Do not discard it. You will need it when you remove the toner cartridge for printer maintenance or other purposes.

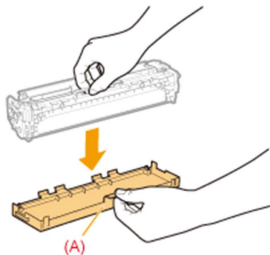

9. Install the toner cartridge. Be careful not to let the drum impact the frame of the toner cartridge tray.

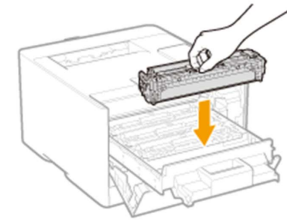



10. Push in the toner cartridge tray.

11. Close the front cover.

? If you cannot close the front cover Make sure that the toner cartridge tray is closed. Do not try to forcefully close the front cover, as this may damage the printer.

CARTRIDGE INSTALLATION

1. Make sure your printer power is on when you replace a new cartridge.
2. When you first install the cartridge, your printer screen will have the following prompt: "The indicated cartridges are non-HP cartridges" and the information button  will flash. Press "OK" to continue.
3. If your printer prompts "Memory error on indicated cartridges, Event Code: 10.00.00" and the information button  is flashing, try opening and closing the printer front door. After that, an on-screen message should read, "The indicated cartridges are non-HP cartridges" and the information button  will flash. Press "OK" to continue.